

2020

GEOGRAPHY (Honours)

Paper Code : V - A

(New Syllabus)

Full Marks : 50

Time : One Hour

**Important Instructions
for Multiple Choice Question (MCQ)**

- Write Subject Name and Code, Registration number, Session and Roll number in the space provided on the Answer Script.

Example : Such as for Paper III-A (MCQ) and III-B (Descriptive).

Subject Code :

III	A	&	B
-----	---	---	---

Subject Name :

- Candidates are required to attempt all questions (MCQ). Below each question, four alternatives are given [i.e. (A), (B), (C), (D)]. Only one of these alternatives is 'CORRECT' answer. The candidate has to write the Correct Alternative [i.e. (A)/(B)/(C)/(D)] against each Question No. in the Answer Script.

Example – If alternative A of 1 is correct, then write :

1. – A

- There is no negative marking for wrong answer.

মাল্টিপল চয়েস প্রশ্নের (MCQ) জন্য জরুরী নির্দেশাবলী

- উত্তরপত্রে নির্দেশিত স্থানে বিষয়ের (Subject) নাম এবং কোড, রেজিস্ট্রেশন নম্বর, সেশন এবং রোল নম্বর লিখতে হবে।

উদাহরণ — যেমন Paper III-A (MCQ) এবং III-B (Descriptive)।

Subject Code :

III	A	&	B
-----	---	---	---

Subject Name :

- পরীক্ষার্থীদের সবগুলি প্রশ্নের (MCQ) উত্তর দিতে হবে। প্রতিটি প্রশ্নে চারটি করে সম্ভাব্য উত্তর, যথাক্রমে (A), (B), (C) এবং (D) করে দেওয়া আছে। পরীক্ষার্থীকে তার উত্তরের স্বপক্ষে (A)/(B)/(C)/(D) সঠিক বিকল্পটিকে প্রশ্ন নম্বর উল্লেখসহ উত্তরপত্রে লিখতে হবে।

উদাহরণ — যদি 1 নম্বর প্রশ্নের সঠিক উত্তর A হয় তবে লিখতে হবে :

1. – A

- ভুল উত্তরের জন্য কোন নেগেটিভ মার্কিং নেই।

Choose the correct answer.
Each question carries 1 mark.

1. In which year India National Sample Survey Organization (NSSO) was established?
(A) 1998
(B) 1950
(C) 1991
(D) 1987
2. The current average annual growth (2019) of world population is —
(A) 3.10%
(B) 4.10%
(C) 1.08%
(D) 8.10%
3. In which year T. R. Malthus published his book “*An Essay on Principles of Population*”?
(A) 1798
(B) 1889
(C) 1791
(D) 1787
4. Among which is not the preventive check of birth control after Robert Thomas —
(A) Late Marriage
(B) Chasity
(C) Moral restraint
(D) Famine
5. According to the 2011 census of India what percent of people belong to the age group of 15-60 years?
(A) 32%
(B) 58.5%
(C) 65.02%
(D) 48.4%

Turn Over

6. Israel belongs to which type of population resource region —
- (A) United States type
 - (B) European Type
 - (C) Brazilian type
 - (D) China type
7. The value of Gender Development Index (GDI) of India during 2019 was —
- (A) 0.409
 - (B) 0.609
 - (C) 0.829
 - (D) 0.995
8. Most of the countries of the Sub-Saharan Africa are in the —
- (A) 2nd of Demographic Stage
 - (B) 1st of Demographic Stage
 - (C) 4th of Demographic Stage
 - (D) 3rd of Demographic Stage
9. In the Indian context, the term ‘de-notified tribes’ refers to —
- (A) Tribes, which are aboriginals
 - (B) Nomadic tribes
 - (C) Tribes practicing shifting cultivation
 - (D) Tribes which were earlier classified as criminal tribes
10. Which one of the following regions of India is now regarded as an “ecological hot-spot”?
- (A) Eastern Himalayas
 - (B) Western Himalayas
 - (C) Western Ghats
 - (D) Eastern Ghats
11. The tribal population in Andaman and Nicobar Islands belong to the —
- (A) Australoid race
 - (B) Mongoloid race
 - (C) Caucasoid race
 - (D) Negroid race

Turn Over

12. Migration which flows from prosperous to less prosperous region is called —
- (A) Return migration
 - (B) Reverse migration
 - (C) Perverse migration
 - (D) None of these
13. Which one of the following is not correct about the liberal liberalisation policy of India —
- (A) Increase in direct foreign investment
 - (B) Increase in industrial recession
 - (C) Development of infrastructure
 - (D) Rise in export
14. The town of Rishra (West Bengal) is known for industry of —
- (A) Cotton textile
 - (B) Jute textile
 - (C) Silk textile
 - (D) Woolen textile
15. Narora nuclear power station is located in the state of —
- (A) Maharashtra
 - (B) Tamil Nadu
 - (C) Uttar Pradesh
 - (D) Rajasthan
16. The minimum forest cover necessary to maintain the ecological balance is —
- (A) 50% of the total land area
 - (B) 25% of the total land area
 - (C) 40% of the total land area
 - (D) 33% of the total land area
17. In which year the Concept of Ecology was established by Ernst Haeckel —
- (A) 1856
 - (B) 1866
 - (C) 1876
 - (D) 1869

Turn Over

18. Special cultural pattern of a geographical area is called —
- (A) Cultural realms
 - (B) Cultural areas
 - (C) Cultural factors
 - (D) None of these
19. Acculturation is the process of —
- (A) Orientation in the negative culture
 - (B) Acquisition of the culture of different society
 - (C) A culture merging with another culture
 - (D) Transmission of culture
20. Who wrote the famous book “*Social Change In India*”?
- (A) C. Marx
 - (B) R. Venedict
 - (C) C. Weber
 - (D) None of them
21. Which of the following is a Scandinavian language?
- (A) Swedish
 - (B) Danish
 - (C) Norwegian and Icelandic
 - (D) All of the above
22. Which of the following soils is particularly deficient in phosphate but is inherently rich in Nitrogen & organic matter?
- (A) Alluvial soil
 - (B) Tarai soil
 - (C) Peaty soil
 - (D) Red soil
23. “*Morphology of Landscape*” is the book written by whom?
- (A) Karl Marks
 - (B) Carl O Sauer
 - (C) Jean Bruhes
 - (D) None of these

Turn Over

24. Which of the following is not the classification of frontiers —
- (A) Natural
 - (B) Cultural
 - (C) Artificial
 - (D) Geographical
25. In which year Mackinder wrote his essay on “Geographical Pivotal” of history —
- (A) 1900
 - (B) 1925
 - (C) 1919
 - (D) 1904
26. “The different forms of an interaction is called social process” who established it —
- (A) MacIver and Page
 - (B) Dr. S. C. Dube
 - (C) Besanj and Besanj
 - (D) Taylor
27. Who introduced models in geography?
- (A) Harvey
 - (B) R. Chorley
 - (C) Weaven
 - (D) Haggett
28. Consider the following about Commuter’s Zone of concentriczone model :
1. This is the peripheral area and farthest from the CBD.
 2. High population density is one of the characteristics of this zone.
 3. Most of the people living here commute to the city everyday for work.
- (A) Only 1 & 3
 - (B) Only 2
 - (C) Only 1 & 2
 - (D) Only 1, 2 & 3

Turn Over

29. Consider the given figure and identify the name of B —

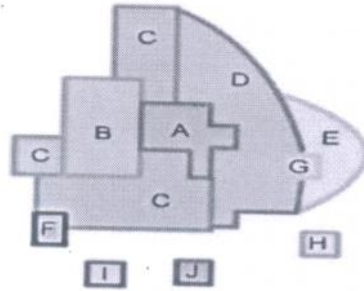

- (A) Whole-sale & Light manufacturing
(B) Low-class residential
(C) Zone of Transition
(D) Heavy manufacturing
30. The tribes most commonly found in Madhya Pradesh are —
(A) Oraon and Munda
(B) Santhal and Oraon
(C) Gonds and Bhils
(D) Bhils and Santhals
31. The book “*Fundamentals of Sociology*” was written —
(A) Gisbert
(B) Ross
(C) Park & Burges
(D) None of them
32. The statement “Culture as a Social Structure” was explained by —
(A) A. Radcliffe Brown
(B) E. W. Zimmermann
(C) Gillin & Gillin
(D) None of them
33. National Program for Conservation and Management of Wetlands is adopted in which year —
(A) 2005
(B) 2006
(C) 2009
(D) 2007

Turn Over

34. Who proposed the concept of geo-politics based on ocean power?
- (A) Mackinder
 - (B) A. T. Mohan
 - (C) Frank Thone
 - (D) Spykeman
35. Which state of India has the first rank in production of rubber —
- (A) Kerala
 - (B) Karnataka
 - (C) Tamil Nadu
 - (D) Andhra Pradesh
36. Which is the best example of Antecedent Boundaries?
- (A) USA & Canada
 - (B) France & Germany
 - (C) India & Pakistan
 - (D) Argentina & Chili
37. In India anticyclones are set up during —
- (A) Winter season
 - (B) Summers
 - (C) Spring
 - (D) Autumn
38. The value of total output of goods and services produced in the country in given time period is termed as —
- (A) Per Capita Income
 - (B) GNP
 - (C) GDP
 - (D) None of them
39. The Great Boundary Fault lies in the state of —
- (A) Gujarat and Rajasthan
 - (B) Himachal Pradesh and Uttarakhand
 - (C) Jammu & Kashmir and Himachal Pradesh
 - (D) Jammu & Kashmir, Himachal Pradesh and Uttarakhand

Turn Over

40. "Man is a product of the Earth's Surface".— This statement is given by —
- (A) Huntington
 - (B) Semple
 - (C) Ratzel
 - (D) None of them
41. "The true and only geographical problem is that of utilization of possibilities. There are no necessities, but everywhere possibilities". This point of view was named by Lucian Febrve as —
- (A) Possibilism
 - (B) Utilitarianism
 - (C) Necessarism
 - (D) Essentialism
42. Who among the following is known as the Father of Human Geography?
- (A) Hartshorne
 - (B) Mark Jafferson
 - (C) Vidal-de Lablache
 - (D) Ratzel
43. Which of the following Union-Territory has the highest sex ratio?
- (A) Dadra and Nagar Haveli
 - (B) Delhi
 - (C) Pondicherry
 - (D) Chandigarh
44. Which of the following coral reefs are identified for conservation and management?
- (A) Gulf of Mannar
 - (B) Andaman and Nicobar Islands
 - (C) Lakshadweep Islands & Gulf of Katchha
 - (D) All of above
45. Which of the following river is NOT originated from the western slopes of the Aravalli range —
- (A) Luni
 - (B) Sakhi
 - (C) Sabarmati
 - (D) Tapi

Turn Over

46. The origin of the radical geography movement can be traced to the late 1960s, especially in the —
- (A) U.S.S.R
 - (B) U.S.A.
 - (C) Germany
 - (D) France
47. In Indian mega cities, which of the following urban agglomeration is the largest?
- (A) Greater Bombay
 - (B) Kolkatta
 - (C) Delhi
 - (D) Chennai
48. According to whom “Morphology is the science of form and structure and development which influence the form”?
- (A) L. D. Stamp
 - (B) G. T. Trewartha
 - (C) R. E. Murphy
 - (D) R. Dickinson
49. In which of the following countries, large proportion of young people is dependent on relatively small work force of the population —
- (A) Developing
 - (B) Under Developing
 - (C) Developed
 - (D) None of them
50. Compact Settlement are mostly found in the —
- (A) Areas rich in minerals
 - (B) Areas are rich in many aquatic resources
 - (C) Highly productive alluvial plains
 - (D) Both B & C
-